

M-2 Ejector Pins



PCS Company's M-2 Ejector Pins are constructed from wear resistant high speed steel. Pin diameters range from 1/32" through 1/4" with lengths of 6" and 10". These pins are through hardened to 60-63 Rc. The diameters are precisely ground to provide dimensional stability and superior surface finish quality.

Features:

- Material: M-2 High Speed Steel
- Hardness: Through hardened to 60-63 Rc
- Diameter tolerance of .0003"
- Eliminate chipping from form work
- Can be used for ejector pin or core pin
- Unit of Measure - Inch

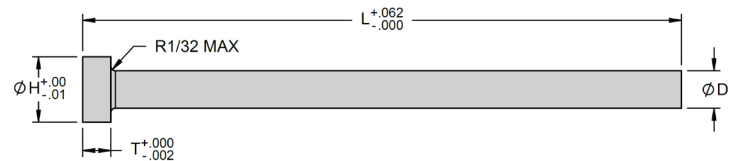

| Item Number | Nominal Pin Diameter | D Actual Pin Diameter | D Tolerance | L Overall Length | H Head Diameter | T Head Thickness |
|-------------|----------------------|-----------------------|----------------|------------------|-----------------|------------------|
| M2P-132-6 | 1/32" | 0.0307 | +.0000/- .0003 | 6" | 0.25 | 0.125 |
| M2P-132-10 | 1/32" | 0.0307 | +.0000/- .0003 | 10" | 0.25 | 0.125 |
| M2P-364-6 | 3/64" | 0.0464 | +.0000/- .0003 | 6" | 0.25 | 0.125 |
| M2P-364-10 | 3/64" | 0.0464 | +.0000/- .0003 | 10" | 0.25 | 0.125 |
| M2P-116-6 | 1/16" | 0.062 | +.0000/- .0003 | 6" | 0.25 | 0.125 |
| M2P-116-10 | 1/16" | 0.062 | +.0000/- .0003 | 10" | 0.25 | 0.125 |
| M2P-564-6 | 5/64" | 0.0776 | +.0000/- .0003 | 6" | 0.25 | 0.125 |
| M2P-564-10 | 5/64" | 0.0776 | +.0000/- .0003 | 10" | 0.25 | 0.125 |
| M2P-332-6 | 3/32" | 0.0933 | +.0000/- .0003 | 6" | 0.25 | 0.125 |
| M2P-332-10 | 3/32" | 0.0933 | +.0000/- .0003 | 10" | 0.25 | 0.125 |
| M2P-764-6 | 7/64" | 0.1089 | +.0000/- .0003 | 6" | 0.25 | 0.125 |
| M2P-764-10 | 7/64" | 0.1089 | +.0000/- .0003 | 10" | 0.25 | 0.125 |
| M2P-18-6 | 1/8" | 0.1245 | +.0000/- .0003 | 6" | 0.25 | 0.125 |
| M2P-18-10 | 1/8" | 0.1245 | +.0000/- .0003 | 10" | 0.25 | 0.125 |
| M2P-964-6 | 9/64" | 0.1401 | +.0000/- .0003 | 6" | 0.25 | 0.125 |
| M2P-964-10 | 9/64" | 0.1401 | +.0000/- .0003 | 10" | 0.25 | 0.125 |
| M2P-532-6 | 5/32" | 0.1557 | +.0000/- .0003 | 6" | 0.281 | 0.1562 |
| M2P-532-10 | 5/32" | 0.1557 | +.0000/- .0003 | 10" | 0.281 | 0.1562 |
| M2P-1164-6 | 11/64" | 0.1714 | +.0000/- .0003 | 6" | 0.343 | 0.1875 |
| M2P-1164-10 | 11/64" | 0.1714 | +.0000/- .0003 | 10" | 0.343 | 0.1875 |
| M2P-316-6 | 3/16" | 0.187 | +.0000/- .0003 | 6" | 0.375 | 0.1875 |
| M2P-316-10 | 3/16" | 0.187 | +.0000/- .0003 | 10" | 0.375 | 0.1875 |
| M2P-1364-6 | 13/64" | 0.2026 | +.0000/- .0003 | 6" | 0.375 | 0.1875 |
| M2P-1364-10 | 13/64" | 0.2026 | +.0000/- .0003 | 10" | 0.375 | 0.1875 |
| M2P-732-6 | 7/32" | 0.2183 | +.0000/- .0003 | 6" | 0.406 | 0.1875 |
| M2P-732-10 | 7/32" | 0.2183 | +.0000/- .0003 | 10" | 0.406 | 0.1875 |
| M2P-1564-6 | 15/64" | 0.2339 | +.0000/- .0003 | 6" | 0.406 | 0.1875 |
| M2P-1564-10 | 15/64" | 0.2339 | +.0000/- .0003 | 10" | 0.406 | 0.1875 |
| M2P-14-6 | 1/4" | 0.2495 | +.0000/- .0003 | 6" | 0.437 | 0.1875 |
| M2P-14-10 | 1/4" | 0.2495 | +.0000/- .0003 | 10" | 0.437 | 0.1875 |